

Triton[®] II Sand Filters

with **ClearPro**
Technology[™]

Model: TR 60



Refer to the Installation & User's Guide (P/N 154901) for important information about the installation, operation and safe usage of this product.

IMPORTANT SAFETY INSTRUCTIONS
READ AND FOLLOW ALL INSTRUCTIONS
SAVE THESE INSTRUCTIONS

For Triton® II Filter's equipped with ClearPro Technology™, the following items have changed:



Triton® II with ClearPro Technology™

High Rate Sand Filter for Swimming Pools or Spas, for Residential or Public Use

Item No.	Part No.	Description	Qty.
13	155284	ClearPro Piping Assy., Lower	1
15	150088	ClearPro Lateral Assy.	6
16	152222	ClearPro Hub Assy.	1
For Use Without ClearPro Technology			
13	154805	Piping Assy., Lower	1
15	150085	Lateral 1/4 Turn Assy.	6
16	154763	Hub Lateral Assy.	1
ALL OTHER ITEMS ARE THE SAME AS THE EXISTING TR 60 FILTER			

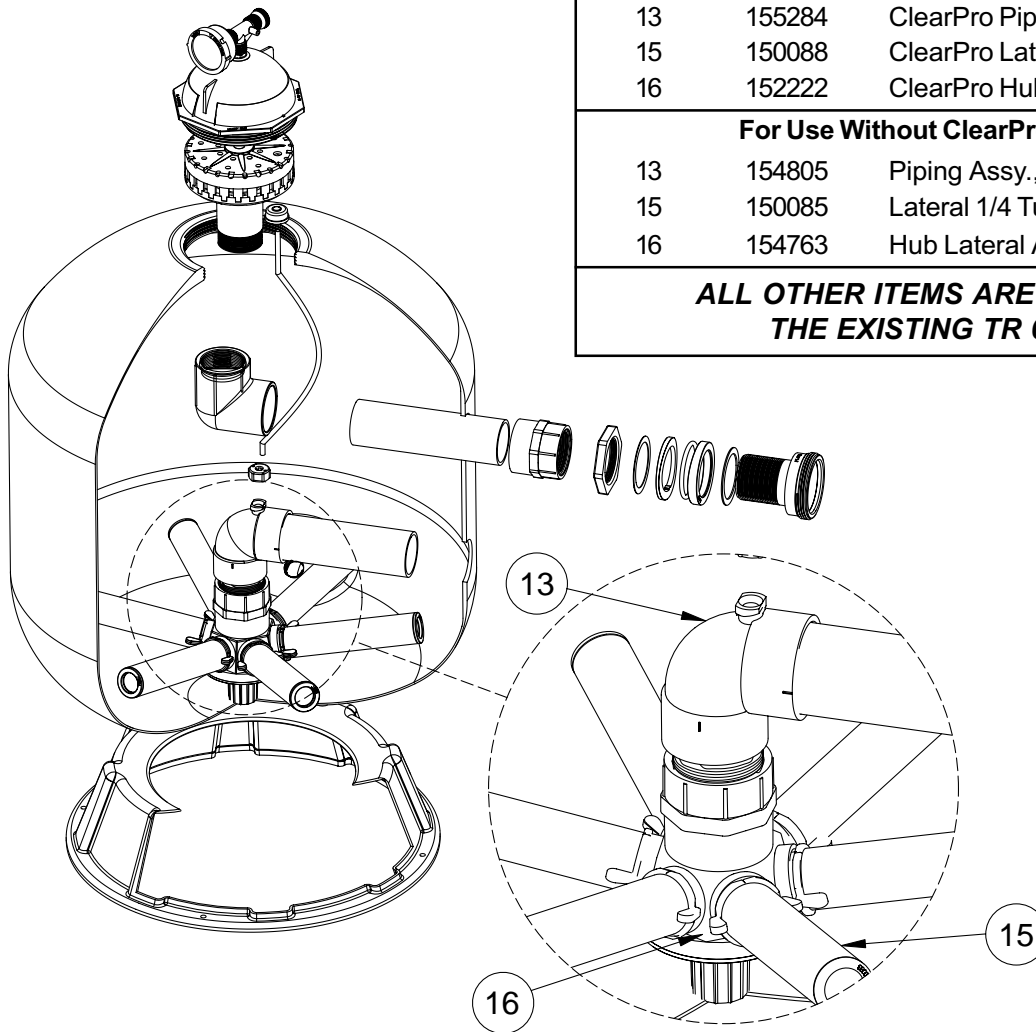

DETAILED VIEW

1620 Hawkins Ave., Sanford, NC 27330 • (919) 566-8000
 10951 West Los Angeles Ave., Moorpark, CA 93021 • (805) 553-5000
 Visit us on the Internet at: www.pentairpool.com or www.staritepool.com



© 2007 Pentair Water Pool and Spa, Inc. All rights reserved.
 This document is subject to change without notice.

P/N 155306 Rev. A 5/22/07